



## Cash for Grass Rebate Application: Single-Family Home

**Please note:** as of October 1, 2018, the program terms and eligibility requirements have changed for the Cash for Grass and Rainwater Harvesting Rebate Program.

**Basic program terms:** Receive \$3.50/square foot (sqft) up to a maximum of \$6000 (per property per lifetime) for removing living grass on your property and replacing with climate appropriate plant material and a watershed component. Some watershed components may also receive up to an additional \$1000 rebate. Projects must be completed within 6 months of receiving official approval from the City's Water Conservation Unit.

### Need Help Getting Started?

Not quite ready to submit an application? Need help creating a design, planning a rainwater harvesting component, or finding an installer? Santa Monica has partnered with landscape professionals who will meet with you at your home and provide expert advice on sustainable landscaping and completing a rebate. This service is \$50.00 for a two-hour consultation to be paid directly to the consultant. (Participation is not required to earn rebate).

A free rainwater harvesting consultation is also available. To schedule a landscape or rainwater harvesting consultation, contact us at [savewater@smgov.net](mailto:savewater@smgov.net) or call (310) 458-8972.

- Before you complete the application you will need to have:**
- Living lawn/turfgrass
  - A basic design sketch of your project (including plants to be installed)
  - Selected a watershed component(s)
  - Selected a watering method (drip irrigation or hand watering)
  - Selected a qualified professional installer if you are not doing the project yourself

### Applicant Information

Property Owner:	Applicant Name (if different than owner):	
Daytime Phone Number:	Email:	
Applicant Type: <input type="checkbox"/> Property Owner <input type="checkbox"/> Tenant <input type="checkbox"/> Designated Person		
Project Location Address	City:	Zip Code:
Mailing Address (if different than project location)	City:	Zip Code:

## Santa Monica Cash for Grass Rebate Application

**Note: Contractors are NOT eligible to receive a rebate check on behalf of clients.**

**Complete the following if the property was issued a building permit for a remodel or new construction since January 1, 2017.**

Building Permit Number(s): \_\_\_\_\_, \_\_\_\_\_, \_\_\_\_\_

Explanation of the Project: \_\_\_\_\_

\_\_\_\_\_

### Project Installer/Contractor (if not installing yourself)

Installer/Contractor Name	Company Name (if applicable)
Daytime Phone Number:	Email:
Santa Monica Business License #:	C-27 License # (optional):
Type of Installer: <input type="checkbox"/> Landscape Contractor <input type="checkbox"/> Gardener <input type="checkbox"/> Irrigation Company <input type="checkbox"/> Undetermined/Self* <i>* If undetermined at time of application please provide installer information at time of pre-inspection</i>	

### How did you hear about this program?

- |   |  |
|---|--|
| <input type="checkbox"/> Friend or Neighbor | <input type="checkbox"/> Bus Ad          |
| <input type="checkbox"/> City Website       | <input type="checkbox"/> Ad in the Paper |
| <input type="checkbox"/> Advertisement      | <input type="checkbox"/> Seascope        |
| <input type="checkbox"/> City Staff         | <input type="checkbox"/> Other _____     |
| <input type="checkbox"/> Social Media       |  |

*New plants need more water to get established, however it is important to not overwater your new landscape as this may result in an exceedance in your Water Use Allowance. For more information on proper watering of your new landscape check out [www.bewaterwise.com](http://www.bewaterwise.com).*

## Santa Monica Cash for Grass Rebate Application

### Project Details and Coverage Calculation

The converted area must contain enough plants to have 50% living plant coverage when the plants are fully-grown. Trees are not included in the coverage calculation. However, for each tree planted in the converted areas (NO new trees are allowed in parkways) the City will rebate up to \$125 per new tree, at a maximum of \$500. For groundcovers, one plant is required per square foot. Hardscapes and mulch do not count toward the 50% plant coverage requirement. To look up plant coverage at maturity go to [www.bewaterwise.com/Gardensoft](http://www.bewaterwise.com/Gardensoft). Use additional sheets for each area (i.e. front yard, parkway, etc.).

Location (select one):

- Front yard    
  Backyard    
  Side yard    
  Courtyard    
  Parkway

### Calculate Your Coverage Requirement

<b>Total estimated sqft of turf to be removed</b>	<b>Calculated Required Plant Coverage (Total sqft Removed X 50% for plants)</b>
	_____ (sqft) X 50% = _____ sqft

Number of new trees to be planted in converted area \_\_\_\_\_ (save your receipts)

### Planting Plan to Meet Coverage

Common Plant Name	Botanical Name	Number of Plants	Mature Coverage (sqft per plant)	Total Coverage (sqft)
<b>Total Plants and Coverage for Area:</b>				

### Sample Calculation

<b>Total estimated sqft of turf to be removed</b>	<b>Calculated Required Plant Coverage (Total sqft Removed X 50% for plants)</b>			
460	_____ 460 _____ (sqft) X 50% = _____ 230 _____ sqft			
Common Plant Name	Botanical Name	Number of Plants to Install	Mature Coverage (sqft per plant)	Total Coverage (sqft)
Nepeta x faassenii	Catmint	12	1.5	6
Dymondia margaretae	Silver carpet	200		200
Coastal Rosemary	Westringia 'Wynyabbie Gem'	5	8	40
<b>Total Plants and Groundcover Coverage for Area:</b>		<b>217</b>		<b>246</b>

# Santa Monica Cash for Grass Rebate Application

## Project Sketch

Use the space below to draw a detailed sketch of your proposed plan. Use additional sheets if necessary.

*Include a minimum, square footage of converted area and the plant materials you plan to use.*

Professional landscape design plans can be submitted in lieu of a sketch and are encouraged. For projects more than 2,500 square feet, a City landscape permit is required, and a complete landscape plan set must be submitted to the City for review and approval. Please view [https://www.smgov.net/Departments/OSE/Categories/Landscape/Landscape\\_Requirements.aspx](https://www.smgov.net/Departments/OSE/Categories/Landscape/Landscape_Requirements.aspx) for a complete list of Plan Submittal Requirements.

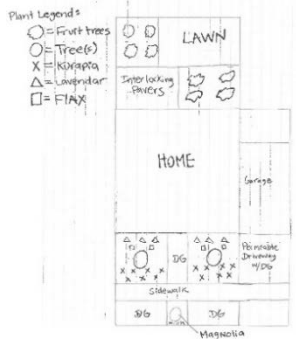
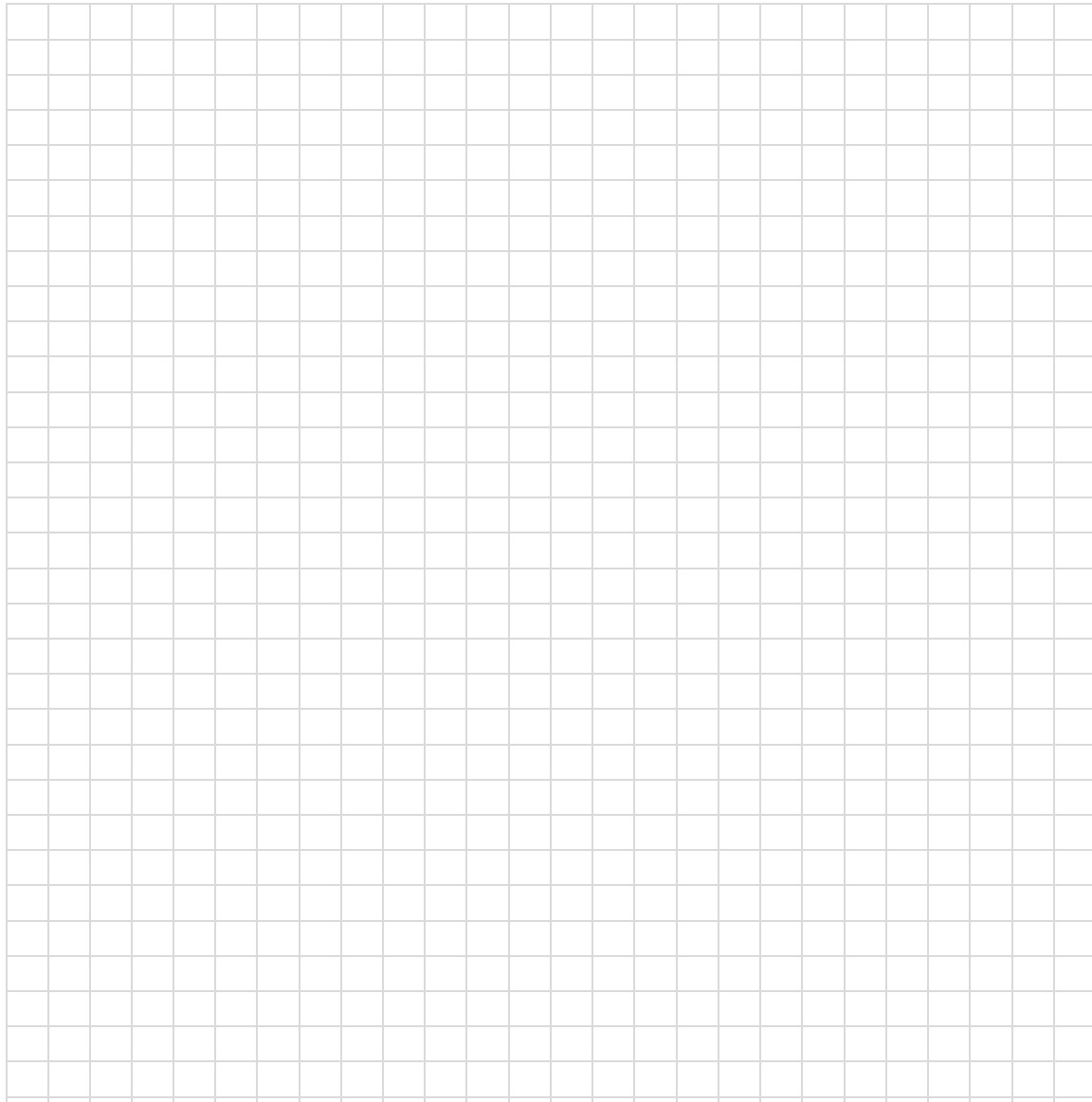

## Santa Monica Cash for Grass Rebate Application

### Watershed Component

Select at least one of the required watershed components listed below to be installed in the converted area. If only converting your parkway then you must install a watershed component somewhere else on your property. By selecting particular watershed components, you can receive an additional rebate! Designate below where you will be installing the required watershed component and any additional components installed.

#### Basic Watershed Component Options: check component(s)

- Berm  Swale  Surface Grading

#### Watershed Components that can get you an additional rebate! (requires a gutter downspout connection)

- |  |                     |                                       |               |
|--|---------------------|---------------------------------------|---------------|
| <input type="checkbox"/> Rain Barrel   | \$200 each, 8 max   | <input type="checkbox"/> Rain Garden  | Up to \$1,000 |
| <input type="checkbox"/> Small Cistern | \$500 each, 4 max   | <input type="checkbox"/> Dry Riverbed | Up to \$1,000 |
| <input type="checkbox"/> Large Cistern | \$2,000 each, 2 max | <input type="checkbox"/> Rock Garden  | Up to \$1,000 |

### Rain Gardens, Rock Gardens and Dry Riverbeds

For rain gardens, rock gardens and dry riverbeds calculate the following in the table below to determine the minimum size required of that watershed component. See the Rain Harvest Rebate Guide for details on designing and installing watershed components.

Roof Area (in sqft)	
Depth of Watershed Component (in ft)	
Footprint of Watershed Component (in sqft)	
Total Storage Capacity (in gallons)	

### Watershed Component and Visibility

Area	Check if visible from street/sidewalk	Sqft to be converted	Watershed Component(s) included
Front yard			
Backyard			
Side yard			
Courtyard			
Parkway*			

\*Parkway is the landscape strip between sidewalk and street.

If completing a project in a parkway, please list the street(s) the parkway runs along:

Street Name(s): \_\_\_\_\_

### Additional Rebate Opportunities for Rainwater Harvesting

These rainwater harvesting options do not meet the required watershed component; however, you can receive an additional rebate by adding these to your project.

- Downspout Redirect (up to \$40/downspout)  
 Permeable Driveways (\$2.00 per sqft up to \$2000)

## Santa Monica Cash for Grass Rebate Application

**By applying for the Cash for Grass and Rainwater Harvest Rebate Program, you agree to the disclaimer and all the terms and conditions outlined in the program checklist.**

### **Disclaimer – Please Read Carefully Before Submitting Your Application**

By applying for a rebate in this program, personal information listed on your application may be subject to disclosure to requesting parties pursuant to the California Public Records Act.

The payee's Social Security or Tax ID number must be provided via a completed Form W-9 along with the rebate application paperwork to receive a rebate. The name on the W-9 must match the name on the rebate check. This form must be completed so that the Form 1099 can be completed in compliance with exemptions to the Federal Privacy Act of 1974, 42 UCS 405 (c )(2)(c ). Social Security numbers provided as part of the application process are held in confidence under terms of the Privacy Act and are not divulged or otherwise conveyed to individuals or organizations outside the Rebate Program. Payees receiving \$10,000 or more in rebate funding are required to complete the Oaks Initiative form prior to final approval and issuance of check.

The City of Santa Monica makes no representation or warranty relating to contracted services or products that may be installed in converted areas. Installation of water efficient devices does not guarantee reduced water use. This application is for the 2018-2019 Cash for Grass Program (Rebate Program) only. Any increase in water use as a result of participating in this program may result in Water Use Allowance exceedance penalties.

By participating in this Rebate Program, you waive and release the City of Santa Monica, their contractors, and agents from any and all claims and causes of action arising out of the purchase, installation or use of devices and materials in connection with this Rebate Program. Any claim you may have based upon any defect or failure of performance of a contracted service or device or material purchased by you should be pursued with the contractor or manufacturer/distributor.

The City of Santa Monica enforces the terms and conditions of the Rebate Program. The applicant is responsible for complying with all applicable laws, codes, policies, covenants, conditions, and restrictions that may apply. All landscaping and irrigation on the property must comply with the City of Santa Monica's Water-Efficient Landscape and Irrigation Standards (SMMC 8.108). Quality, appearance, and maintenance of the converted area are the responsibilities of the applicant.

The City of Santa Monica may apply additional restrictions or change program requirements. The Rebate Program is available on a first come, first served basis for a limited time while funds are available. Payees receiving \$10,000 or more in rebate funding are required to complete the Oaks Initiative form prior to final approval and issuance of check. Each property may combine any, all, or none of these rebates at one time on one application. Properties that received funding for landscape and irrigation rebates are not eligible to receive funding for the same type of rebate; they can participate in other rebate types.

The City of Santa Monica requires on-site inspections for approval of compliance with the Rebate Program terms. The City reserves the right to request and review receipts and invoices prior to approval. The City reserves the right to inspect all landscape areas during the final inspection appointment. Payment will not be processed until approval is granted. The City of Santa Monica may take and use photos of the property, landscape and project for reporting and marketing. All rights are reserved by the City of Santa Monica for all photography taken and used for reporting and marketing.

By checking "I agree," the applicant agrees to comply with the program terms and conditions, as well as all federal, state, and local codes, including covenants, policies, conditions and restrictions, as applicable. The applicant has read, understands and agrees to the terms and conditions of the program as outlined and certifies that the information on the application is true and correct.

I agree to the Disclaimer and the Terms and Eligibility for the Cash for Grass and Rainwater Harvesting Rebate Programs.

I understand I must review, sign, and return and comply with the Installation Requirements Form and a completed Form W-9 to receive eligibility for my rebate.

Applicant's Signature:

Applicant Name:

Date:

Property Owner's Signature (if different):

Property Owner Name:

Date:

FOR INTERNAL USE ONLY			
Date Received:	Processed by:	Approved (Y/N)	Date Approved